



Professional Wash & Wax

CLEAN & FINISH

SOFTENS AND LIFTS DIRT LEAVING A HIGH GLOSS SHEEN



PRODUCT DESCRIPTION

Highly concentrated formulation for high volume economical use, 1 US gallon capable of washing approximately 200 vehicles. High foaming, slick, smooth formula, softens and removes harsh contaminants without scratching; leaving a high shine, protective layer.

PRODUCT INFORMATION

Size	Part No.	Ctn. Qty.
500ml	7206	6
1 US gallon	7218	1
5 US gallons	7219	1

TECHNICAL INFORMATION

Appearance: yellow liquid
 VOC Content: 20g/L
 Relative Density: 1.04 - 1.08
 pH: 7.5 - 9.5
 Silicones: none

HIGHLY CONCENTRATED

SAFE ON ALL SURFACES

DOES NOT REMOVE EXISTING WAX LAYERS

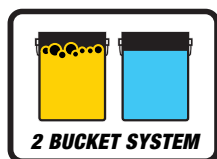

The 2 bucket system:
 Bucket 1 = a mixture of 20ml of product (about 2 capfuls) per 10 ltr of lukewarm water
 Bucket 2 = clean, lukewarm water

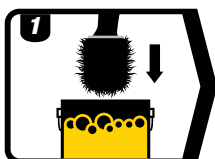

Place a **G3 Pro Lambs Wool Wash Mitt** into the Wash & Wax solution



Wash vehicle, with the soaked mitt, in sections

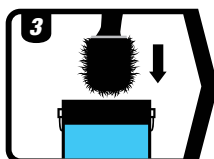

Clean the mitt in the lukewarm water to remove dirt between washes



Place the clean mitt back into the solution and clean the rest of the vehicle, washing the mitt between uses

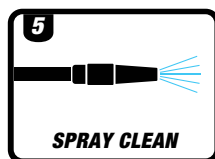

Rinse off soapy residue and dry with a **G3 Pro Drying Towel** or **G3 Pro Super Soft Microfibre Fleece**



AS USED BY PROFESSIONALS

+44 (0)1920 465 041 | enquiries@farecla.com | www.G3Pro.com