

Advanced Collision Repair Systems

Everything you need to reduce cycle times and increase profits!



We Design the Future of Collision Repair Systems!

Car-O-Liner is one of the leading providers of collision repair systems in the world

Today, more than 40,000 Car-O-Liner collision repair systems are in use in more than 70 countries. The development of every Car-O-Liner product is based upon years of hands-on experience and know-how gathered from car manufacturers and collision repair facilities around the world.

Through our devoted team of engineers we design the future of collision repair systems

Time and time again we have made important landmarks. We were the first to introduce a universal repair bench with a mechanical measuring system in 1973, and the first to introduce a computerized electronic measuring system. SPEED - a cutting edge collision repair system enabling shops to repair cosmetic sheet metal damage and perform other repair and service operations in a single setup! SPEED will keep the larger benches free for structural and frame repairs increasing workshop capacity.

Now we introduce Car-O-Tronic Vision X3 – the fastest, most accurate and easiest to use computerized measuring system available!

To meet our customers' increasing demand for one-stop shopping we have expanded our product range to include a wide selection of collision repair products.



Experience Car-O-Tronic Vision X3 – the fastest, most accurate and easiest to use computerized measuring system on the market today!

Our customers all agree on what makes Car-O-Liner stay ahead of competition

Car-O-Liner’s collision repair equipment is the best made, the easiest to learn, the simplest to use, the best backed and the most productive - and productivity means profits!

Upgrade your shop with the best the world has to offer in collision repair equipment - from Car-O-Liner!

Reading this brochure is the first step towards higher productivity

With Car-O-Liner equipment in your shop, your customers - the vehicle owners and insurance companies - will experience complete satisfaction from your work. Contact your local distributor for more information.



Car-O-Liner’s Mark 6 demonstrating its flexible 10-ton draw-aligner.



Table of contents	
BODY AND FRAME ALIGNMENT SYSTEMS	
Bench Rack™	
- A universal collision repair system for cars, vans and light trucks	pag 4
Mark 6™	
- Mobile alignment system for cars and light trucks	pag 6
SPEED™	
- Versatile alignment system for cars, pick up’s and suv’s	pag 8
Performance Track	
- Floor based alignment system for cars, vans and light trucks	pag 9
Computerized 3D measuring systems	
Car-O-Tronic Vision™ X3	
- New computerized measuring system	pag 10
Car-O-Tronic Classic™	
- Computerized measuring system	pag 12
Mechanical measuring system	
Car-O-Mech™	
- Mechanical 3D measuring system	pag 13
Miscellaneous	
Accessories	pag 14
Service	pag 15
Training	pag 15

Body & Frame Alignment systems

BenchRack™

A Universal Collision Repair System

The BenchRack systems are designed to hold and lift virtually any type of vehicle. From small cars to light trucks and vans. Including unibody and full frame vehicles..

Rack Up your Profits

With the unique tilt feature all BenchRacks have drive-on capability for faster setup time, faster inspection and faster repair. To give you more productivity and ultimately more profits.

User-friendly Solutions

Assisted by the integrated lift you will always work at the most comfortable height. A generous amount of space between vehicle and bench gives greater accessibility and efficiency with underbody work. BenchRack components are easily locked to the bench by means of cam locks

Tailormade to Meet your Every Need

With several models to choose from and optional component packages a BenchRack system can be tailored to meet the exact needs of your shop.

Picture shows a fully equipped BenchRack 5500



Powerful 10-ton draw-aligners pull from almost any angle around the vehicle.

Down pulls are made easy with optional attachment (D90).



Car-O-Liner BenchRack with the unique tilt-feature has drive-on capability for faster set-up time, faster inspection and faster repair.

The universal truck clamp and bench mounting combination provides the strongest no-slip holding capacity for full frame vehicles.

BenchRack Measuring Systems

Enhance your system with either one of our 3D computerized measuring systems, Car-O-Tronic Vision X3 or Car-O-Tronic Classic or with our 3-dimensional mechanical measuring system, Car-O-Mech



Removable ramp sections lift out easily to give better access to the vehicle.



DATA

Available models:

All with lifting capacity	4.200 kg/9.200 lbs
- BenchRack 4200:	Length 4.200 mm/13.6 ft
- BenchRack 5000:	Length 5.000 mm/16.4 ft
- BenchRack 5500:	Length 5.500 mm/18.0 ft
- BenchRack 6300:	Length 6.300 mm/20.7 ft
- BenchRack Combi:	Length 5.000 mm/16.4 ft, bench frame with a fixture adaptor kit

Main accessories:

- Computerized measuring system:
Car-O-Tronic Vision X3; Car-O-Tronic Classic
- Mechanical measuring system: Car-O-Mech

Alignment systems

Mark 6™

The Mobile Bench System...

Car-O-Liner's Mark 6 is a bench system with improved lifting capacity and working height with the added convenience of drive over mounting.

A set of four swiveling wheels with brakes makes the bench, with vehicle, fully mobile

...that Sets Your Production in Motion

It's designed around the idea that the more flexible a collision repair system is, the more productive it will be.

Combined to Perfection

Car-O-Liner offers a series of Mark 6 systems. All optional accessories are compatible and interchangeable. Mark 6 means flexibility in getting the combination of equipment best suited for your business.

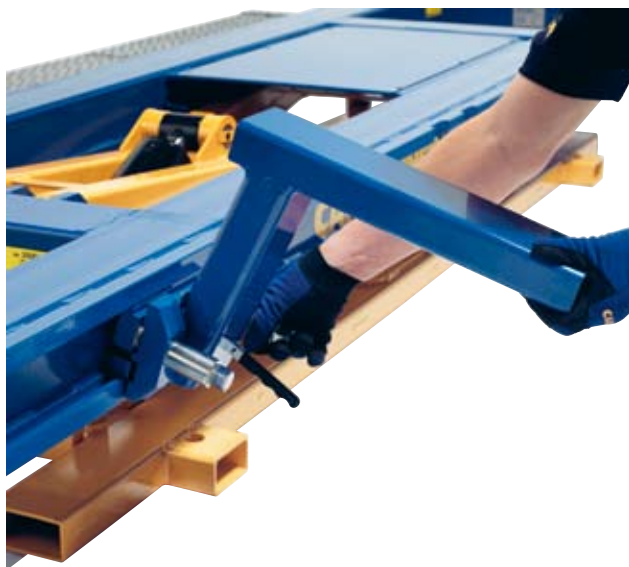

Optional mounting arm clicks in and out for faster loading and unloading (B310).





Approach ramps that easily can be converted into wheel stands, that gives excellent working conditions.



Higher bench arms facilitate maximum work space between bench and underside of vehicle, over 300 mm.



Optional chassis clamp (B110) offers faster setup and removal using just two bolts.

DATA

Available models:

Mark 6: Length 4.060 mm(13.3 ft)
Lift capacity: 2.800 kg/6,160 lbs

Main accessories:

- Chassis clamp (B110) for faster setup/removal
- Mounting arm (B310) for faster loading/unloading
- 3D Computerized measuring system:
Car-O-Tronic Vision X3, Car-O-Tronic Classic
- 3D Mechanical measuring system: Car-O-Mech
- Holding system for light trucks and full frame vehicles
- Specialty clamps, Mercedes, BMW, Honda and others.

Alignment systems

Speed™

Realign cosmetic sheet metal damage and perform other repair and service operations in a single setup with SPEED. It improves the workflow because the movement of the car between work stations is not necessary. This increases efficiency and improves turn around time benefitting the workshop as well as insurers and vehicle owners.

SPEED is Perfect for Well-equipped Collision Repair Shops ...

SPEED is the right choice for collision repair shops that already have one or more full-size alignment benches. Transfer superficially damaged cars to the SPEED lift to keep large benches free for structural and frame repairs.

... and for Light Repair and Paint Shops

SPEED is also the ultimate choice for vehicle repair and paintwork shops wanting to expand operations and branch out into light bodywork.

SPEED Benefits your Staff and Finances

The ergonomic design simplifies the work and ensures faster progress. Accessibility is excellent because there are no ramps or posts around the vehicle. The car can easily be raised to the most comfortable height.



The SPEED Lifting Platform is available with a snap-in draw aligner for use in one end (SPEED) or in both ends (SPEED Plus). Laser-cut components in high-durability steel guarantees high precision in dimensions and solid mounting for the supporting arms and the draw aligner.

Universal 5-ton pull chain.

Stable compound leverage floor lift built of high-strength steel (HSS) profiles.

Double cylinders and mechanical safety lock.

Hydraulic Power Unit for wall or floor mounting.

5-ton draw aligner with "snap-in" mounting.

Foot pump for the draw aligner .

Lifting pad extensions.

DATA

Available models:

Speed: Total weight 622 kg/1.371 lbs
Length 2.510 mm/8.2 ft
Max. vehicle weight 2.500 kg/5.500 lbs
Collapsed height 4 inches

Speed Plus: Total weight 700 kg/1.543 lbs
Length 2.883 mm/9.4 ft
Max. vehicle weight 2.500 kg/5.500 lbs
Collapsed height 4 inches

Accessories:

- eMC LT for comparative measuring
- Specially clamps; Mercedes, BMW and HONDA



The draw aligner can be adjusted to any position. It is self locking and easy to mount

Alignment systems

PT 2500™ Tower

Save Space and Money!

Performance Track is a floor based collision repair system. It is both affordable and space efficient and thereby ideal for shops where space cannot permanently be dedicated to a conventional bench system.

It can also add additional pulling capability to your shop when you need it

Quick and Easy to Install Features

Install the track plate sections in the configuration best suited to your needs.

A powerful and flexible 10-ton pulling tower provides 360 degrees pulling access



DATA

Technical data:

- 1.2 meter floor track plate sections
- 10 ton hydraulic pulling tower
- Height 1.700 mm, 67 inches
- 18 pots
- 6 track plates



Performance Track is quick and easy to install.

3D Computerized Measuring System

Car-O-Soft Vision[™] X3

Powerful and Accurate

The latest addition to our product range is Car-O-Tronic Vision X3 – the most powerful measuring system available. The sensor-equipped Measuring Slide with built-in versatile Remote Control and protective rubber “Bumper-Zones” delivers real-time data three times per second to the advanced and easy-to-use software. Being photobased and backed by the world’s most comprehensive vehicle database it allows you to accurately and quickly target measuring points

Easy to Learn and Use

The unit is easy to learn and use with automatic centering and measuring capabilities, few measurement steps, user-friendly menu and access to the unique Infocenter. Document the

entire repair process in pictures with text and e-mail files to insurance companies directly from within the software.

New functions in Vision X3:

- Worldwide VIN decoding system makes it easy to find the correct data and vehicle in the biggest vehicle database on the market.
- Suspension Check Diagnosis.
- Upper Body Measuring on ALL vehicles including Full Frames, Light Trucks and SUV’s.
- Surface Damage Diagnosis.
- Multimedia Support for Car-O-Liner’s new modular Anchoring, Side Support and Universal parts fixturing (Holding) System.

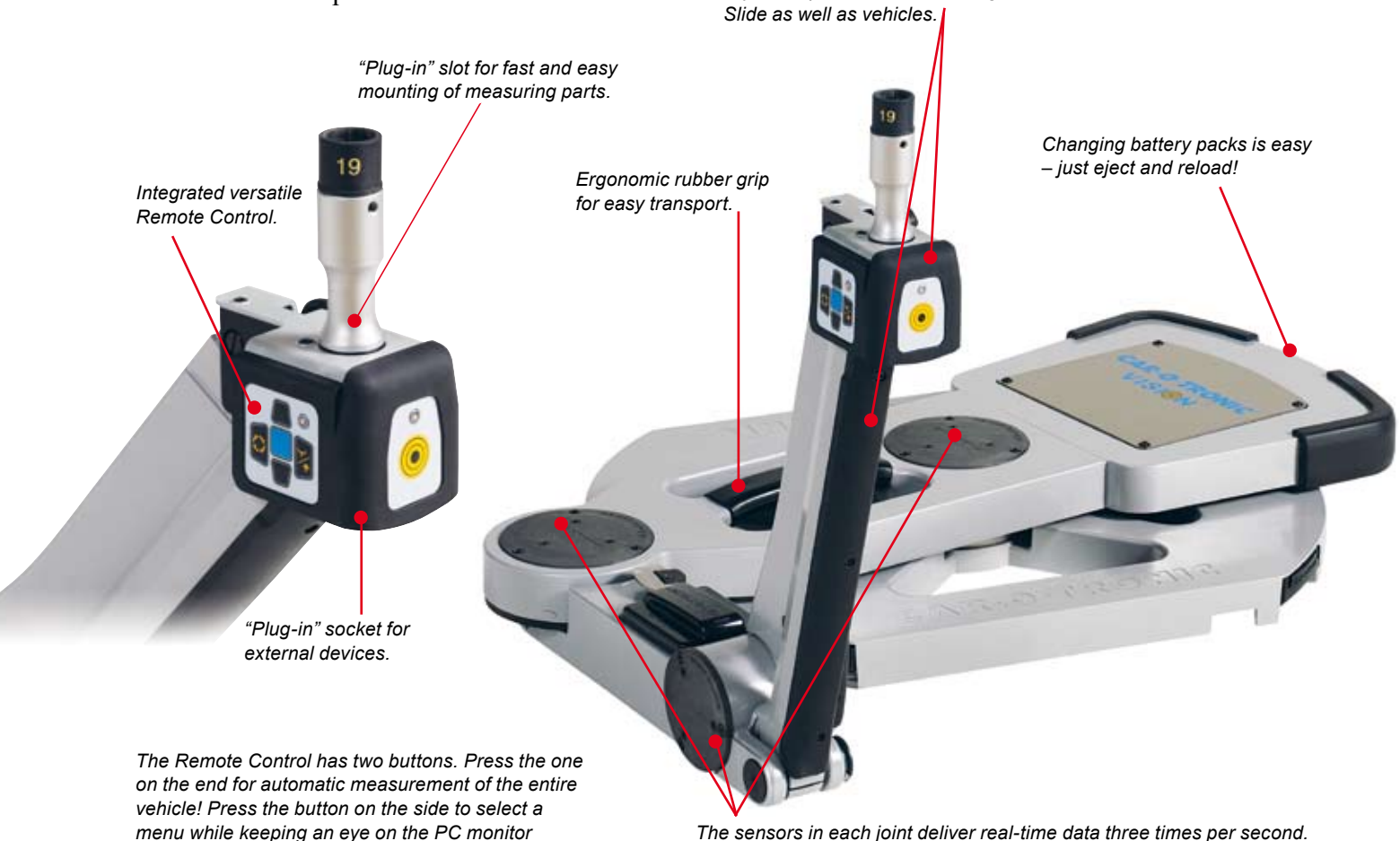

Get All You Need from the Infocenter

The Infocenter, a unique software feature, provides nearly unlimited possibilities for updating vehicle data, news, support and interactive training.

PC Cabinet

The protective PC Cabinet gives easy access to your PC, monitor and printer. The Measuring Slide and the High-Measuring Point Adapter are both stored inside the cabinet.

Measuring with Car-O-Tronic Vision X3 is quick and easy:



Register the work order and enter car make and model.



Conduct measurement, aided by the unique ASP function (Automatic Search Point). Advanced automation allows the system to always select the right point.



Print out the results and you are done!



Car-O-Soft Vision X3 software is advanced, user-friendly and filled with new and exciting features. It is simple to learn and use with automatic centering and measuring capabilities, fewer measurement steps, user-friendly menus and access to the Infocenter. Seamlessly integrated in the software, Car-O-Data provides invaluable data from the most comprehensive vehicle database in existence today. Covering over 10,000 models it always supplies current and reliable reference data for the measuring system.

Compartment for the High-Measuring Point Adapter and Measuring Slide.

Printer bay and keyboard tray.

Convenient compartment for PC and accessories.

Protective rubber "Bumper-Zones".



The monitor will be safe from scratches, dust and dirt behind the optional Monitor Cover.

DATA

System includes:

- Measuring Slide
- Measuring Bridge
- High Measuring Point Adapter
- PC Cabinet
- Measuring Parts
- Extra battery

Software:

- Car-O-Soft Vision X3
- Car-O-Data

Internet:

- Vision Data

3D Computerized Measuring System Car-O-Tronic Classic™

For Dependable and Fast Results

Car-O-Tronic Classic is a photo-based measuring system. Actual vehicle photos allow you to precisely and quickly target measuring points. You can measure any point, anytime while monitoring the pulling process.

The damage and several measuring points are shown graphically on screen during the repair. Finally, a print-out can be made documenting that the vehicle is accurately repaired.

The system gives the speed and accuracy you need for better and more efficient repairs!



*The PC Cabinet gives easy access to computer, monitor and printer.
The Measuring Slide stores safely inside the cabinet.*

Car-O-Tronic Classic can handle both diagnostics and repair. Sensors supply real-time measuring data three times per second.

DATA

System includes:

- Measuring Slide
- Measuring Bridge
- PC Cabinet

Software:

- Car-O-Soft Classic
- Car-O-Data

The World's Largest Vehicle Database

Virtually every vehicle on the road today can be found in the Car-O-Tronic Classic database. With crucial measurement references available at your finger tips it is certain to be a profitable addition to your shop!.

Works with Any Bench

Adapter Kits make the system fully compatible with almost any alignment bench. It is also easy to move because of its small size. Analysis and diagnosis of damage can be performed even before raising the vehicle on the repair bench, thus saving time and keeping bench systems free.

Using Car-O-Tronic Classic is easy:



Fill in the work order.



Center the measuring system by following the on-screen instructions.



Measure the entire vehicle with a press of a button.

Aided by photos, the software shows the exact location of the nearest measuring point and interprets distances.



Print the results.



The software contains advanced measuring functions, access to the photo-based vehicle database covering more than 10,000 vehicles, diagnostic tools, manuals, charts over accessories and spare parts as well as scaled chassis diagrams for the majority of vehicles.

3D Mechanical Measuring System Car-O-Mech™

The Original 3-dimensional Measuring System

Since we launched Car-O-Mech, many competitors have tried to copy us. However, they have never managed to duplicate us. This is due to the high precision engineering in every detail of Car-O-Mech. The measuring system consists of a measuring bridge, measuring slides, adapters, and a tool wagon as well as Car-O-Print and Car-O-Data. Car-O-Mech together with the quality and accuracy

Complete and Accurate Vehicle Information

Car-O-Print is the first photo-based software designed for a mechanical measuring system. It quickly tells you all you need to know about almost every vehicle in existence. With Car-O-Data you will receive current information quarterly, covering more than 10,000 vehicles.

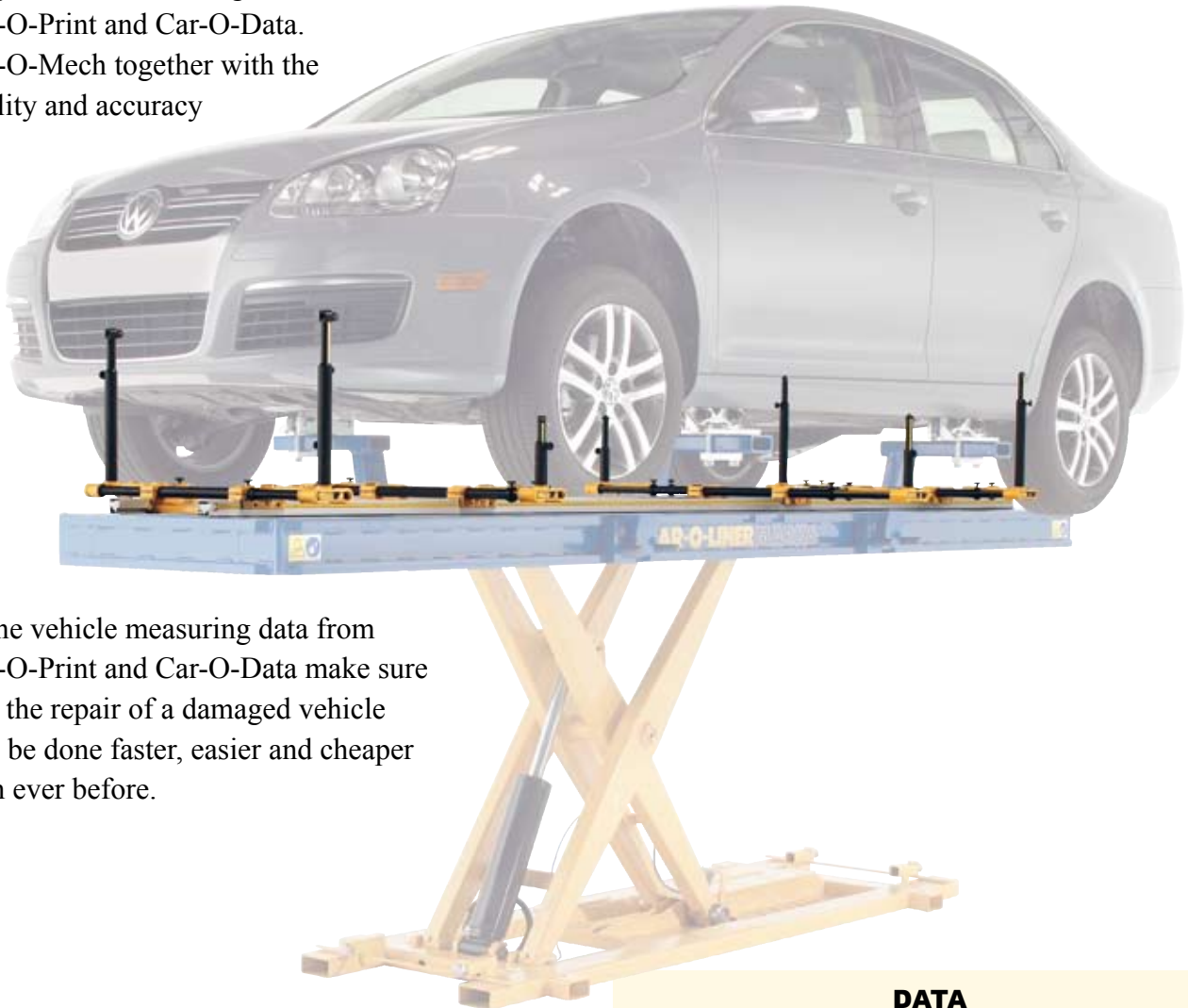

of the vehicle measuring data from Car-O-Print and Car-O-Data make sure that the repair of a damaged vehicle will be done faster, easier and cheaper than ever before.

Car-O-Mech's Measuring Bridge, Measuring Slides and Measuring Parts.

DATA

System includes:

- Car-O-Print 2000 software
- Car-O-Data
- Measuring Bridge
- Measuring Slides
- Measuring Parts
- Data sheets
- Tool wagon for accessories



EVO System

The new Universal Holding & Anchoring System for the future

The EVO System is modular and upgradable. The EVO System is integrated with Car-O-Liner's Data and Software and supports the complete vehicle repair process with Multimedia, Instructions and Data. Our revolutionary concept – The EVO System will contribute to maximize our customers business performance.

EVO 1, Basic Anchoring

The basic system for anchoring, holding and side support during repair, including 3 towers, Multi Purpose Clamp, Track plates, Bushings with adapter, Chain holder and Torque Bar for heavy operations. Excellent multimedia support and help are included in the package.



EVO 2, Extended Anchoring

Extension system to EVO 1, made for anchoring, holding and side support during repair, 2 extra towers and track plates, special tools for Rear axel bracket, Torque Bar extensions, Adjustable holders. Excellent multimedia support and help are included in the package.



EVO3 - Universal Holding & Fixturing System

Universal Holding and Fixturing System for parts during vehicle body repair, the new generation universal system from Car-O-Liner. The combination Car-O-Tronic Vision and the Car-O-Liner EVO System replaces the need to rent or buy a set of Jigs for each vehicle, Car-O-Liner EVO System is universal and made for all vehicles on the market yesterday, today and tomorrow !

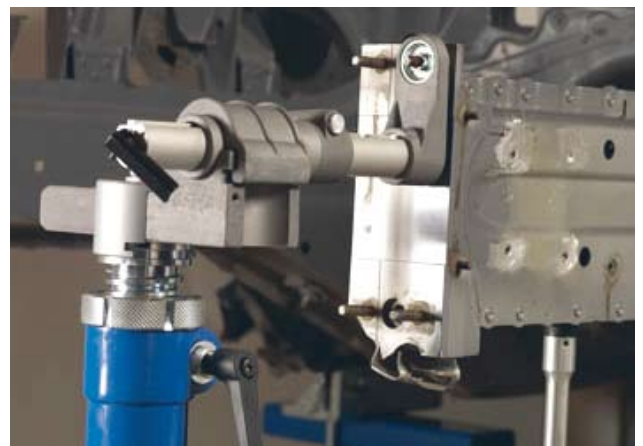

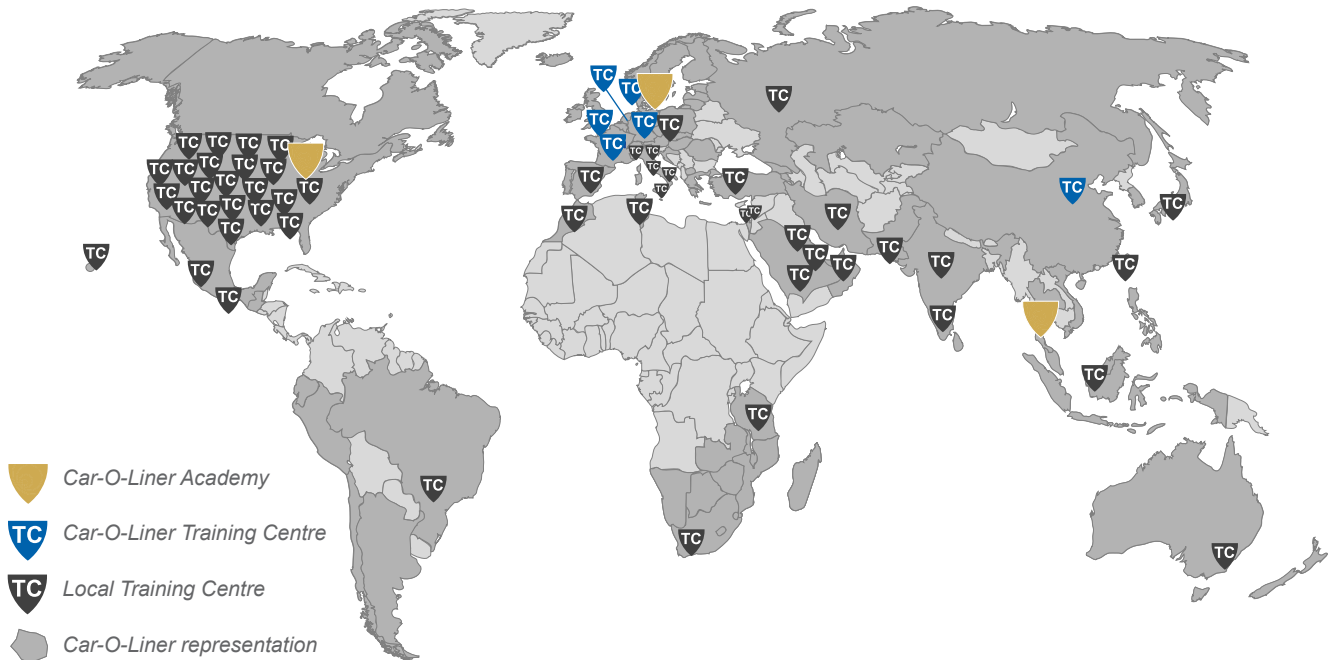

The Power of Knowledge

For Car-O-Liner the final results of the Collision Repair Process are the most important ones and not only in quality terms but also in terms of efficiency.

It means that not only the repair equipment need to be highly efficient but also the technicians need to be fully comprehensive for new materials, equipment, methods and process thinking.

For Car-O-Liner, as a global player, it is important to have a well established network of Training Centres.

For us it is just as important to be close to the car producers as well as to the technicians. Our framework bases for Car-O-Liner Academy are Kungsör Sweden, Wixom US, and Bangkok Thailand. From there we serve and support our subsidiaries and distributors in more than 60 Training Centres with training material and courses.

Always, with the aim to increase knowledge and efficiency in the Collision Repair Process.



Car-O-Liner is a Leading Global Provider of Assured and Profitable Alignment Processes to the Automotive Industry, including Technical Development, Training and Service. Over 40 000 Car-O-Liner Collision Repair Systems are in use worldwide. Car-O-Liner runs operations of its own in Scandinavia, USA, UK, France, Germany, Thailand and China and sells through local distributors in more than 70 countries.

Car-O-Liner products are well known for their high quality, advanced technology and ergonomic design.

Car-O-Liner and Josam are both part of the Alignment Systems Group. Car-O-Liner is focused on servicing the car and light truck industry while Josam is focused on heavy duty vehicles.



Box 7 • SE-736 21 Kungsör • Sweden. Telephone +46 227 412 00 • Telefax +46 227 319 00
www.car-o-liner.com • info@car-o-liner.se